

Excelon® Pro
Lockout/shut-off valve
ø 6 ... 12 mm, G 1/8 ... G 3/8

Selected options provides ease of ordering

Configuration flexibility

Excellent value

No tools required for assembly

RoHS compliant

**Technical data**

Medium:

Compressed air

Operating pressure:
12 bar max.

Flow:

CV = 2,57 (G 1/4)

Ambient temperature:

-20°C* to +60°C

* Consult our Technical Service for use below +2°C

Ordering information

See page 2

Materials:

Body and valve stem: PBT

Internal parts: Acetal

Elastomers: Nitrile and TPE

Standard model

Port Size	Model	Flow (Cv factor)	Weight kg
G 1/4	T92T-2G-B1N	2,57	0,16

Ordering example

Lockout/shut off valve - G 1/4 with mounting bracket
 3-port/2-position with threaded exhaust port.
 Quote: T92T-2G-B1N

Options selector

T92★-★★-B1N





Function	Substitute
2-port/2-position, non exhaust outlet, black slide	B
3-port/2-position, threaded (M5) exhaust outlet, red slide	T

Connector with mounting bracket	Substitute
6 mm Push-In fitting	6D
8 mm Push-In fitting	8D
10 mm Push-In fitting	AD
12 mm Push-In fitting	BD
G 1/8	1G
G 1/4	2G
G 3/8	3G

Connector without mounting bracket	Substitute
G 1/4	2V

Connector	Substitute
Without	NN

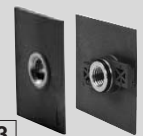
Accessories

	Push-in fitting connector with mounting bracket	Threaded connector with mounting bracket	Threaded connector without mounting bracket
			
	1	2	3
Port size			
G1/8	-	9212KIT-1G	-
G1/4	-	9212KIT-2G	9211KIT-2V
G3/8	-	9212KIT-3G	-
ø 6 mm	9213KIT-6D	-	-
ø 8 mm	9213KIT-8D	-	-
ø 10 mm	9213KIT-AD	-	-
ø 12 mm	9213KIT-BD	-	-
			
	7	9	
	9236-88/X10 (quantity 10)	T40M0500	

Warning
 Locking plates **MUST** be in place before pressurizing any Excelon Pro unit.

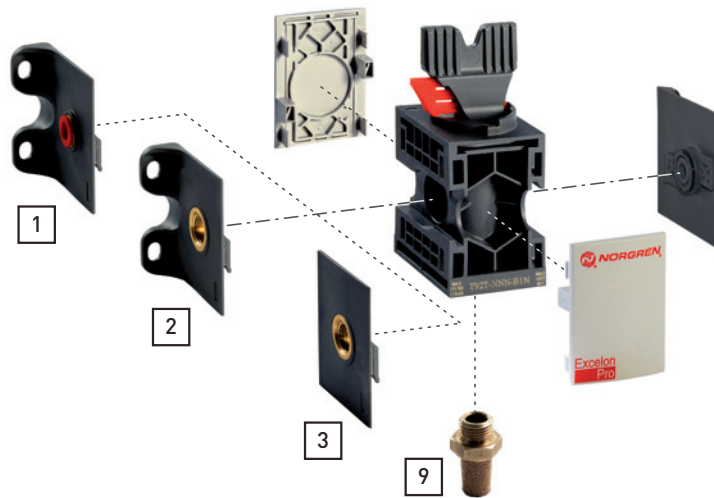

Shut-off valve with wall mounting bracket

Shut-off valve without mounting bracket

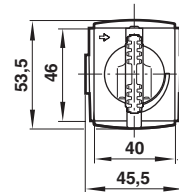
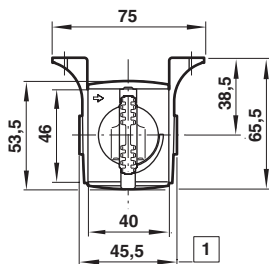
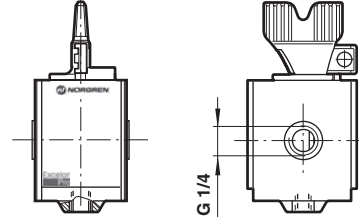
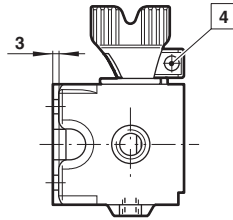
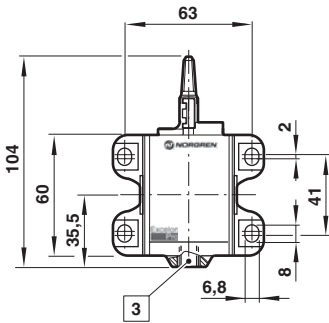

- 1 Connector Dimensions**
1/8" and 1/4" threaded connectors shown. See below for port-to-port dimensions for additional connectors.

PIF Connector	Port-to-port
6 mm, 8 mm	60
10 mm, 12 mm	62
Threaded connector	
1/8", 1/4"	45,5
3/8"	76

- 3 M5 exhaust port**
- 4 Lever lockable only in closed position. Standard clip accepts ø 7 mm shackle.**

Warning

These products are intended for use in industrial compressed air systems only. Do not use these products where pressures and temperatures can exceed those listed under **'Technical Data'**.

Before using these products with fluids other than those specified, for non-industrial applications, life-support systems, or other applications not within published specifications, consult NORGREN.

Through misuse, age, or malfunction, components used in fluid power systems can fail in various modes.

The system designer is warned to consider the failure modes of all component parts used in fluid power systems and to provide adequate safeguards to prevent personal injury or damage to equipment in the event of such failure.

System designers must provide a warning to end users in the system instructional manual if protection against a failure mode cannot be adequately provided.

System designers and end users are cautioned to review specific warnings found in instruction sheets packed and shipped with these products.